

Washing Machine

ESSENTIALS

INSTRUCTION MANUAL

6KG WASHING MACHINE

C612WM17

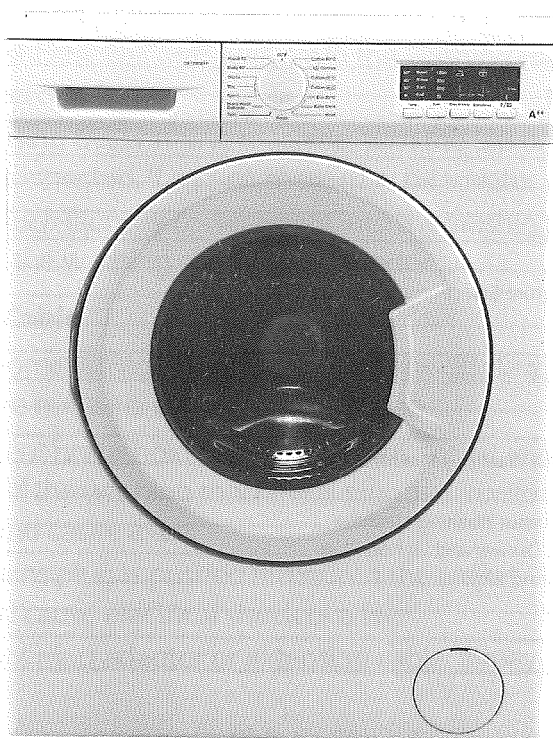

Currys 

Contents

Safety Warnings	3
Unpacking	5
Moving and Installing	6
Removing the Transit Bolts	6
Moving the Washing Machine from One Location to Another	6
Installing Your Washing Machine	7
Choosing the Right Location for Your Washing Machine	7
Hose and Cable Lengths	8
Levelling the Washing Machine	8
Water Supply Hose	8
Connecting to the Mains Supply	9
First time use	9
Product Overview	10
The unit	10
Control Panel	11
Preparation	12
Preparing Laundry	12
Adding Detergent and Softener	12
Selecting the Programme	13
Which Detergent to Use	14
Wash Setting	14
First washing operation	14
Standard Washing	14
Manual Soaking	15
Half-load detection system	15
Optional Functions	15
Washing Water Temperature Selection	15
Easy Ironing	16
Extra Rinse	16
How to Set the Child Lock	16
Finishing programme	16
Removing Laundry	16
Maintenance - Cleaning the Washing Machine	17
Cleaning the Drum	17
Cleaning the Exterior of your Washing Machine	17
Cleaning the Detergent Drawer and Siphon Plug	17
Cleaning the Door Seal and Window	17
Cleaning the Drain Filter	18
Product Fiche	19
Specification	20



Safety Warnings

IMPORTANT SAFETY INSTRUCTIONS READ CAREFULLY AND KEEP FOR FUTURE REFERENCE

WARNING!

- If you will not be using the washing machine for a while such as when you go on holiday, turn off the water supply to the washing machine. This is particularly important if there is no drainage around the washing machine. If the water is left on, water pressure may build up and cause a leak.

General Use

- This washing machine is for household (domestic) use only.
- Do not install your washing machine anywhere that is damp or exposed to the weather. If you do, it may cause an electric shock, fire, failure or deterioration.
- Keep flammable substances well away from the washing machine. They may cause an explosion or a fire.
- Before you start using the washing machine, turn the tap on to check that the hose is properly connected. If it's not, there may be a water leak.
- Do not put too much laundry or detergent into the washing machine. It may cause issues with the washing machine or laundry.

Power Source and Cable

- Make sure your home voltage matches the voltage displayed on the washing machine. If you are not sure, contact an electrician.
- Use an independent household dedicated mains socket, rated at 13 Amp 220V to 240V AC. If the washing machine is plugged in with other appliances, it may overheat and cause a fire.
- Make sure the mains plug is pushed firmly into the socket. A loose connection may overheat and cause electrical shock or a fire.
- Do not use a mains plug adaptor or extension cable. It may overheat and cause a fire.
- The mains plug must remain accessible to allow disconnection or an all pole switch must be incorporated in the fixed wiring in accordance with the wiring rules.
- Check the mains lead and mains plug for any damage. If the mains cable is damaged, it must be replaced by the manufacturer, its service agent or similarly qualified persons in order to avoid a hazard.
- Unplug the mains lead when cleaning the washing machine.

- Do not touch the mains lead or mains plug with wet hands. It may cause an electric shock.
- Check the mains plug regularly for dirt. If dirt accumulates on the mains plug, it could cause a fire. To prevent this, unplug the cable and clean the mains plug with a dry cloth.
- If you disconnect the mains plug, hold onto the mains plug not the cable. Pulling the cable may cause an electric shock or a fire.

To Prevent Injury / Damage

- When opening and closing the door ensure you keep fingers away from the door hinge.
- Do not wash, rinse or spin water-proof sheets or clothing. These may cause vibration or washing machine failure during spin-drying, which could lead to injury, damage to the washing machine or damage due to water leaking.
- Be careful when draining hot water or any detergent from the washing machine.
- Do not dismantle, repair or modify the washing machine. The washing machine could malfunction and cause a fire or injury.
- This appliance can be used by children aged from 8 years and above and persons with reduced physical, sensory or mental capabilities or lack of experience and knowledge if they have been given supervision or instruction concerning use of the appliance in a safe way and understand the hazards involved. Children shall not play with the appliance. Cleaning and user maintenance shall not be made by children without supervision.
- Children of less than 3 years should be kept away unless continually supervised.
- The mains water pressure must be 0.1MPa - 1MPa.
- The appliance is to be connected to the water mains using the new hose-set supplied. Old hose-sets should not be reused.
- Do not connect to the hot water supply.
- The ventilation openings in the base of the washing machine must not be obstructed by a carpet.
- Ensure the transit bolts are removed before installation.



IT IS HAZARDOUS FOR ANYONE OTHER THAN AUTHORISED SERVICE PERSONNEL TO CARRY OUT SERVICING OF REPAIRS WHICH INVOLVE THE REMOVAL OF COVERS.



TO AVOID THE RISK OF AN ELECTRICAL SHOCK DO NOT ATTEMPT REPAIRS YOURSELF.

Unpacking

Remove all packaging from the unit. Retain the packaging. If you dispose of it please do so according to local regulations.

The following items are included:

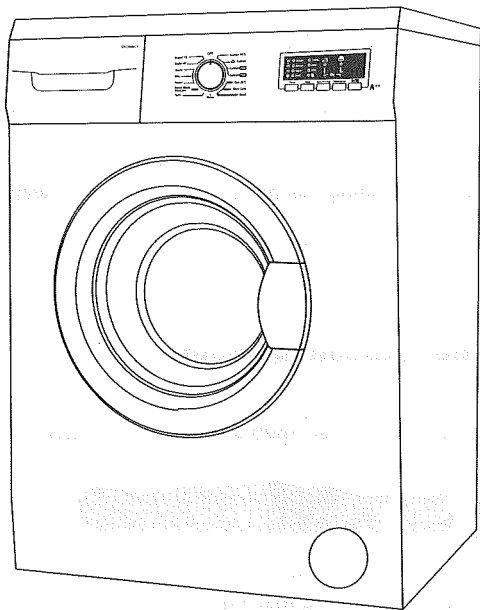

The Main Unit

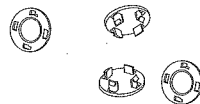

Transit Bolt Cover Cap x 4

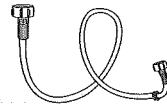

Water Supply Hose x 1

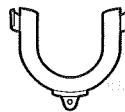

U-Shape Drain Hose Holder x 1
For fixing the water drain hose.



If items are missing, or damaged please contact Partmaster (UK only).
Tel: 0344 800 3456 for assistance.

Moving and Installing

Removing the Transit Bolts

Four transit bolts keep the interior of the washing machine in place while it's being moved. They need to be removed before installation. Use a spanner (not supplied) and follow the instructions detailed below.



Don't run the washing machine without removing the transit bolts, as this can cause excessive vibrations and may damage your machine.

1. Use a spanner to loosen the four bolts. They are located at the rear of the washing machine.
2. Pull the bolts out horizontally. Make sure the entire bolt is removed.
3. Push the four cover caps (included with your accessories) into the respective bolt holes.

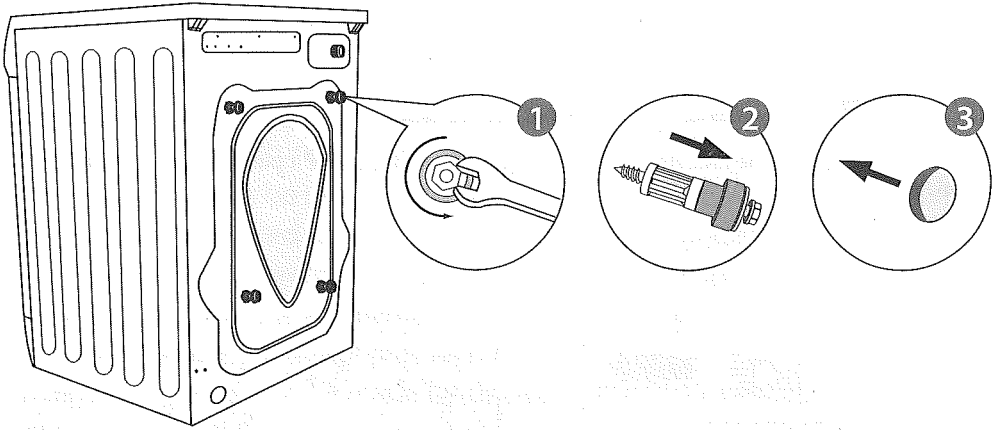

You'll need the transit bolts again if you move the washing machine, so make sure you keep them in a safe place.

Moving the Washing Machine from One Location to Another

Before you move the washing machine:

- Shut off the tap and run the washing machine to drain the water. Drain any remaining water from the pump hose.
- Disconnect the mains cable.
- Attach the transit bolts.



Two or more people are required to move the washing machine.



Make sure to fix the transit bolts prior to moving the washing machine.

* All images are for indication only; please refer to your individual unit for actual item.

Installing Your Washing Machine

Please read and follow the instructions carefully.

- In addition to the instructions mentioned here, special regulations of the relevant water and power supply companies may apply. If in doubt, have the washing machine connected by a qualified technician.
- The washing machine is heavy - caution when lifting it. Do not lift by projecting components (e.g. washing machine door).
- Warning: Frozen hoses may tear/burst. Do not install washing machine in outdoor areas or where there is a risk of frost.
- Lay hoses and cables in such a way that there is no risk of trapping or kinking.



Additional space (approximately 60mm) is required for the rear of the washing machine. This is to allow enough space for the water hose and drain hose connections.

Choosing the Right Location for Your Washing Machine

- Make sure there's enough space for your washing machine.
- Install your washing machine on a flat, stable surface to avoid excessive vibration and noise.
- The ventilation openings in the base of the washing machine must not be obstructed by carpet.



Two or more people are required to move the washing machine.

- Start by tilting the washing machine backwards.
- One person should stand behind it, holding the rear of the top panel. The other person should grip the bottom feet at the front.
- We recommend that you entrust the installation of the washing machine to a qualified technician.

INSTALLATION

Hose and Cable Lengths

How to connect from the left side

How to connect from the right side

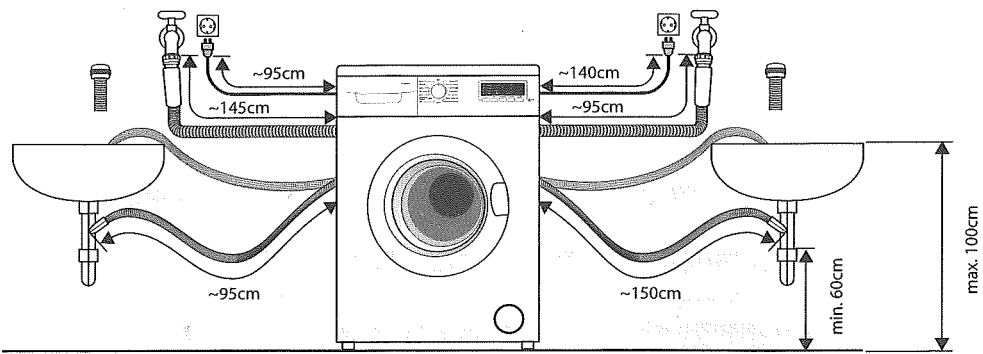

Levelling the Washing Machine

There are 4 levelling feet on the underside. They **MUST** be adjusted to make sure the washing machine is level.

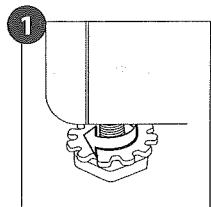

1 On each foot, loosen the lock ring by turning clockwise.

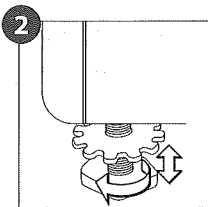

2 Adjust all four feet by rotating each upwards or downwards.

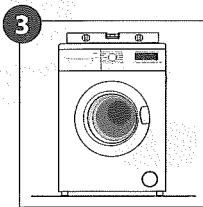

3 Use a spirit level to ensure the washing machine is level.

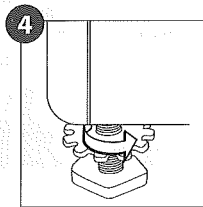

4 Tighten each lock ring by turning them anti-clockwise (towards the washing machine body).

Ensure all four lock rings are tightened securely. Check the feet are still bolted to the washing machine - if they're unbolted, the washing machine will move around.

Water Supply Hose

Points to remember

- Follow the instructions in this section to avoid water leaks.
- Don't connect the hose to a combination tap.
- Don't twist, squash, modify or cut the hose.
- This machine is designed to connect to the cold water supply. Do **not** connect to the hot water supply.
- Use only the new water supply hose supplied. Old hose sets should not be reused.
- The mains water pressure must be 0.1MPa - 1MPa.
- If your washing machine is delivered in freezing weather conditions, leave it at room temperature for 24 hours after you've set it up before using it. This ensures there's no ice blocking the water supply hose. If your water supply hose freezes, add 2 or 3 litres of warm water to the drum. Then run a "Spin" only programme.

* All images are for indication only; please refer to your individual unit for actual item.

INSTALLATION

Connecting the Water Supply Hose

1. To prevent leakage from the connection joints, ensure the rubber washer seals are fitted to each end of the water supply hose. Do not use without the seals in place.
2. Fit the straight end of the water supply hose to the cold water tap.
3. Connect the angled end of the white headed hose to the water inlet valve on the machine. Hand tighten the plastic parts of the connections. If you are unsure, please call a qualified plumber.
4. Open the tap slowly and check that there are no leaks around the connection joints.

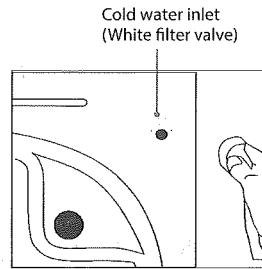
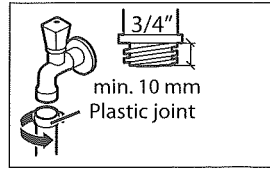
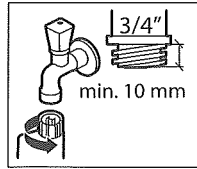

Draining to a sink or wash-basin

- Secure the drain hose in position, so it can't drop out of the basin.
- Don't block the basin's drain outlet, and make sure that the drainage through is sufficient to prevent overflowing.
- Don't let the tip of the drain hose dip into the drained water, as this can cause the water to flow back into the washing machine.

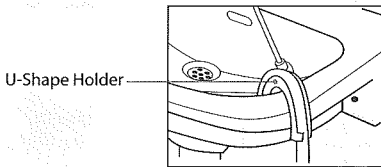

Draining to a wash-basin

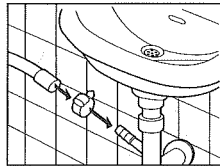

Draining to a drain hose



When connecting to the drain ensure the blanking plate has been removed.

Connecting to the Mains Supply

For your safety:

- Do not use a mains plug adapter or extension cable.
- If the mains cable or mains plug are damaged, disconnect from the main, stop using them and call a qualified technician for assistance.
- Mains cord of your washing machine is equipped with an Earthed plug. This plug must always be inserted to an earthed socket capable of supplying 13 Amps. If you don't have such a socket and fuses in your house, please call a qualified electrician.

First time use

Some water may be left in your machine due to tests carried out during production. To dispose of this water, it is recommended to perform the first washing operation with the programme (Cotton 90°C) and without laundry by inserting ½ portion of detergent in 2nd compartment of the detergent drawer.



During initial start-up and use of the unit, there may be a slight smell while the motor is settling in. This is not a fault; this is normal operation.

* All images are for indication only; please refer to your individual unit for actual item.

Product Overview

The unit

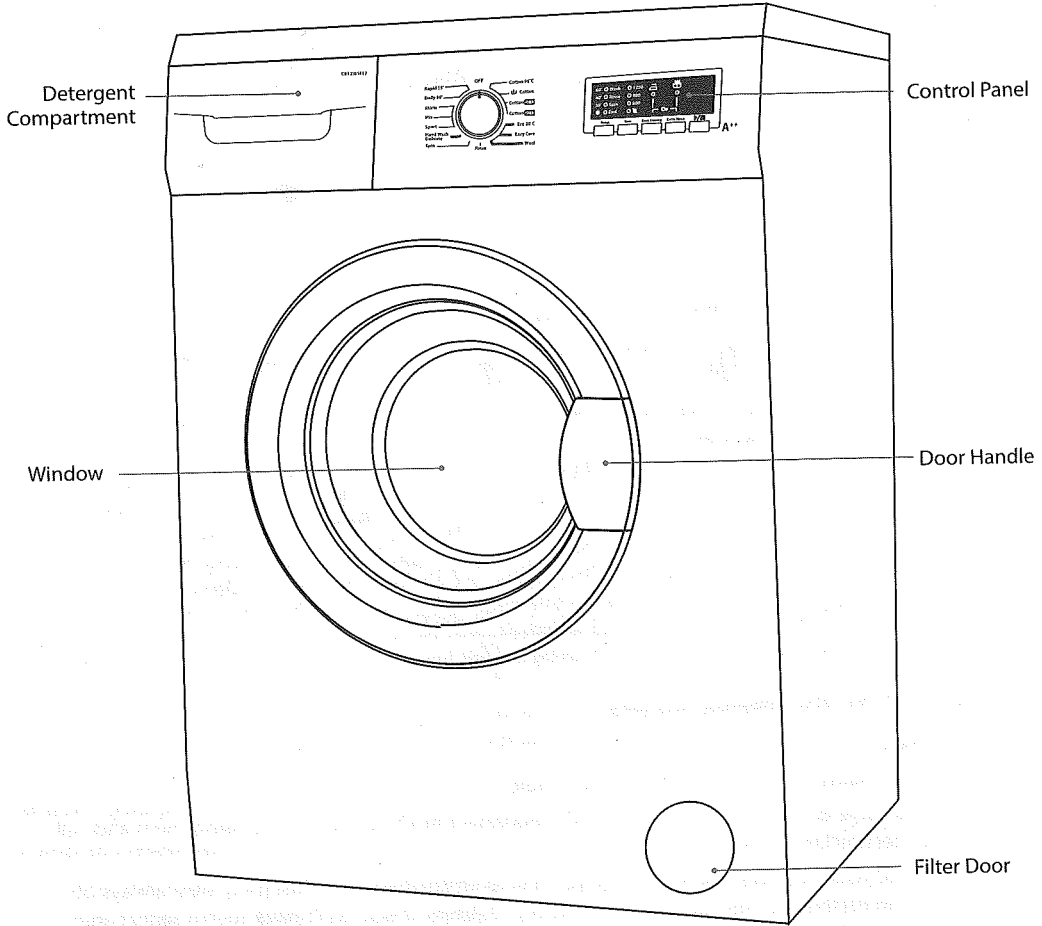

Control Panel

Digital Display

- Only the relevant phase currently in operation (wash, rinse, spin) will be displayed during the washing process.
- When the child lock function is selected the Easy Iron and Extra Rinse LEDs will Flash when a button is pressed.

Power and Programme Selection Dial

Different wash programmes can be selected according to your wash requirements.

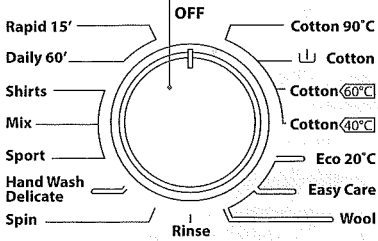

Progress

This shows you the progress of your wash program.

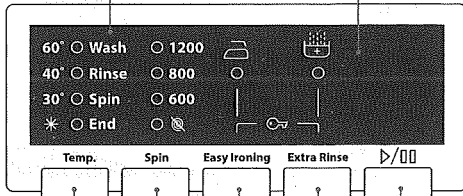

Temp

This button is used to adjust the washing temperature before starting the selected program.

90°C (all LEDs are off)
- 60°C - 40°C - 30°C
- * (cold)

Spin

This button is used to adjust the spin speed during the spin drying stage before starting the selected program.

1200 - 800 - 600 - OFF

Easy Ironing

Extra Rinse

Start / Pause

Child Lock



If you want to cancel any programme running:

- Switch the programme knob to **OFF** position.
- Your machine will stop the washing operation and the programme will be cancelled. (Ensure the Child Lock is off, otherwise the original programme will continue.)
- To empty the water accumulated in the machine switch the programme knob to any programme.
- Your machine will perform the necessary discharge operation and cancel the programme.
- You can then select a new programme.

Preparation

Read the following to understand how best to prepare your laundry for washing.

Preparing Laundry

- Check that pockets do not contain any objects which may damage your clothes and the washing machine.
- To prevent any large, heavy objects (e.g., buckles, large buttons, etc.) from hitting the glass door, turn your clothing inside out, or remove the heavy objects. These could damage your laundry or the washing machine.
- For small items use a washing net.

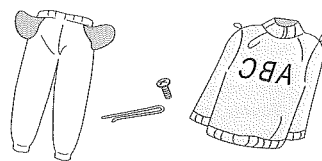

Adding Detergent and Softener

- Add detergent into the appropriate dispenser.
- Apply softener before you start washing.
- Apply detergent and softener according to the washing amount, the soiling level, the water hardness in your area and the manufacturer's instructions of these products.
- For slightly dirty clothes, do not pre-wash and put a small amount of detergent in compartment 2 (II) of the detergent drawer.
- For excessively dirty clothes, select a programme including pre-washing, use $\frac{1}{4}$ of the detergent to be used in the detergent drawer in compartment 1 (I) of the detergent drawer and the remaining amount in compartment 2 (II).

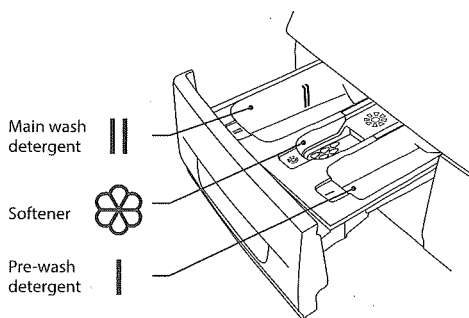

Dilute viscous fabric softener and fabric conditioner with water. Prevent blockage of the overflow. Maximum level is 40ml.

- Do not use washing machine when the detergent drawer is removed. It may cause a water leak or it may not work normally.
- If you forget to add detergent, you can drain the washing machine by running a spin only programme. Then you can add detergent and start the programme again. Detergent only reaches the drum when water flushes through the detergent drawer.
- To prevent powdered detergent staying in the drawer, dry the inside of the drawer with a cloth. Make sure the powder isn't lumpy when you add it into the drawer.
- If the rinse cycle isn't removing all the detergent from your wash, use less detergent.
- Softener should not exceed the MAX level in the compartment.
- Wash out unused softener with a splash of water or a damp cloth after the programme has finished.
- You can use your liquid detergents in all programmes without prewashing. For this, fit the liquid detergent level plate from the accessories bag into the 2nd compartment of the detergent drawer and set the amount of liquid detergent according to the levels on this plate. Remember to detach the liquid detergent plate when done.
- Do not put too much laundry or detergent into the washing machine. It may cause issues with the washing machine or laundry.

Selecting the Programme

Here are the available programmes, additional functions and option settings.
Spin speed can be selected separately for certain programmes.

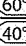
Program	Description	Prewash Function ¹	✓	Max Temperature	Max Load (kg)	Preset Setting		
						Default Spin (rpm)	Approximate Time (Min)	
Cotton	1 90°C	For average soiled cottons, household	NOT Available	✓	90°C	6.0*	1200	179
	2 	linens and work / play clothes.	Pre set	✓	60°C	6.0*	1200	164
	3 		NOT Available	✓	60°C	6.0*	1200	200
	4 		NOT Available	✓	40°C	6.0*	1200	195
5 Eco 20°C	For less than average soiled cottons, household linens and work / play clothes.	NOT Available	✓	20°C	3.0**	1200	96	
6 Easy Care	Very dirty or synthetic-mixed textiles.	NOT Available	✓	40°C	3.0	800	89	
7 Wool	For machine washable woollens.	NOT Available	✓	30°C	2.0	600	39	
8 Rinse	Separate rinse procedure	NOT Available	X	Water temp	6.0	1200	36	
9 Spin	Separate spin procedure	NOT Available	X	-	6.0	1200	15	
10 Hand Wash Delicate	Laundry recommended for hand wash or sensitive laundry	NOT Available	✓	30°C	2.0	600	90	
11 Sport	Sportswear	NOT Available	✓	30°C	3.0	800	80	
12 Mixed	Dirty cotton, synthetics, colour and flax textiles can be washed together.	NOT Available	✓	30°C	3.0	800	79	
13 Shirts	Dirty cotton, synthetics, and synthetic mixed shirts/blouses can be washed together.	NOT Available	✓	60°C	3.0	600	105	
14 Daily 60'	60 minute wash	NOT Available	✓	60°C	3.0	1200	60	
15 Rapid 15'	15 minute quick wash for lightly soiled laundry	NOT Available	✓	30°C	2.0	800	15	

* Maximum of 3kg of towelling material. ** Maximum of 2kg of towelling material.

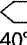

-  Standard washing cycle programs are the Standard 60° C Cotton Program and the Standard 40°C Cotton Program. These cycles are suitable for cleaning naturally-soiled laundry and are the most efficient washing cycles in terms of combined energy and water consumption.
- For all washing programs, please following the detergent recommendations on the garment label or on the detergent's packaging.
- Washing times depend on the program type, ambient water temperature and wash load (weight and type).
- Energy and water consumption will vary according to wash load and type, extra functions, tap water and ambient temperatures.
- The actual water temperature may differ from the declared cycle temperature.
- Your washing machine will automatically detect if you have only inserted half a load or less of laundry, it will automatically reduce the washing time, water consumption and energy in some programs.
- Your washing machine has an Auto Balance feature. Washing times will be longer if the laundry in the drum needs to be balanced.

Which Detergent to Use

The care label is crucial to ensure correct detergent selection, temperature and laundry treatment.

Washing and type of textile	Washing temperature	Detergent
Boil washable white washing made of linen or cotton	30°C - 90°C (Max)	Standard detergent containing bleach and optical brighteners
Coloured washing made of linen or cotton	30°C - 60°C (Max)	Colour detergent without bleach and optical brighteners
Coloured washing made of easy-care fibres, synthetic materials	30°C - 60°C (Max)	Colour/mild detergent without optical brighteners
Delicate fine textiles, silk or viscose	30°C - 40°C (Max)	Mild detergent
Wool	30°C - 40°C (Max)	Detergent for woolens

Wash Setting

First washing operation

Some water may be left in your machine due to tests carried out during production. To dispose of this water, it is recommended to perform the first washing operation with the programme (Cotton 90°C) and without laundry by inserting ½ portion of detergent in 2nd compartment of the detergent drawer.



During initial start-up and use of the unit, there may be a slight smell while the motor is settling in. This is not a fault; this is normal operation.

Standard Washing

1. Pull the door handle and put the laundry in the drum. Make sure no laundry gets caught in the door.
2. Close the door and turn the **Programme Dial** to select your wash programme and water temperature.
3. Adjust the temperature (if required). The temperature can not be set higher than the programmes set temperature.
4. Adjust the Spin Speed (if required).
5. Select any Optional Functions.
6. Add detergent into the detergent drawer. The quantity of detergent will depend on the amount of laundry, the degree of soiling and the water hardness. Use the amount of detergent suggested on the packaging of the detergent.

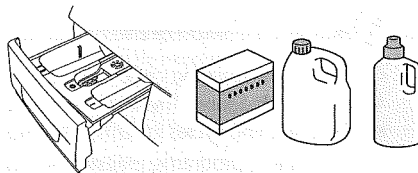

To pause the programme you have selected, press the **Start / Pause** button. The electronic display will blink when the machine is in pause mode.

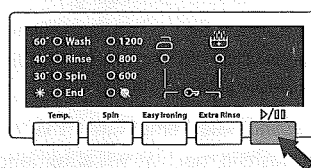

7. Press the **Start / Pause** button to start the washing.
8. The washing machines **End** LED will light when the programme is complete.



- If the door is locked and you switched the washing machine off - or if there's a power cut - it will stay locked for 2 minutes.
- If the machine is full of water, do not open the door.

Manual Soaking

To manually soak your laundry, press the **Start / Pause** button after 10 minutes of the wash programme. The washing machine will suspend the laundry to soak it in the water. After your desired soaking time, press the **Start / Pause** button, the machine will continue the previous wash.



When you start your machine, the following are indicated on the electronic display.

- Indication of the current wash cycle process wash, rinse or spin.
- The spin speed set.
- Optional setting - you can select Easy Iron or Extra Rinse.

Half-load detection system

Your machine features a half-load detection system. In case you load machine to approximately half or less than the maximum laundry capacity, your machine will run so as to save washing time, water consumption and energy in some programmes (White cotton 90°, Colourfast cotton 60°, Non colourfast cotton 40°). When half load function is active, the machine can complete the programme you have set in a shorter time.

Optional Functions

Depending on the programme you select, you can combine different optional functions.

- Press the button of the optional function you would like to select.
- If the indication of the function button remains lit it means that the function has been selected.
- If the indication of the function button is flashing it means you cannot use that additional function for the wash programme you selected.

Reason for non-activation:

- The optional function you want to use in the washing programme you have selected is not applicable.
- Your machine has passed the stage, during which the optional function you want to select would be implemented.
- It is not compatible with an optional function you have selected previously.

Washing Water Temperature Selection

You can select the washing water temperature with the washing water temperature adjustment button.

You can gradually decrease the washing water temperature between the maximum temperature of the selected programme and cold washing by repeatedly pressing the **Temp** button.

If you have missed the washing water temperature you want, continue and the temperature selection will loop back around.

Temperature Cycle

90° (no LED lit) - 60° - 40° - 30° - * (cold)

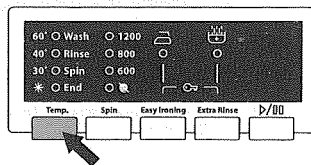

Easy Ironing

By using this function, you can ensure your clothes come out less wrinkled after washing.



The easy ironing spin speed is set to 800. However you can manually reduce the spin speed by pressing the **Spin** button.

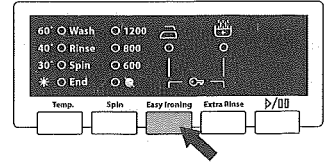

Extra Rinse

You can add an extra rinse at the end of your washing cycle if you wish.

- Press the **Extra Rinse** button, the extra rinse LED will light.

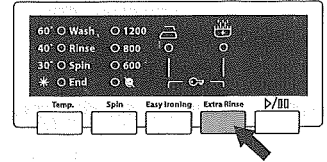

How to Set the Child Lock

The Child Lock prevents children from stopping programmes accidentally. It only locks the control buttons not the **Programme Dial**.

Switch the washing machine on.

1. When the washing machine is operating, press and hold **Easy Ironing** and **Extra Rinse** button for 3 seconds. The Easy Iron and Extra Rinse LEDs will blink 3 times.
2. Press the buttons in the same way to unlock.

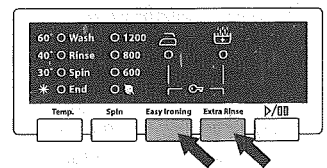

The child lock will switch off automatically at the end of the wash programme.

Finishing programme

- Your machine will stop by itself as soon as the programme you have selected finishes.
- The door lock will release and the **End** LED will light.

Removing Laundry

1. Open the washing machine door and remove your laundry.
2. Remove any foreign objects to avoid risk of rusting.
3. Leave the door and detergent drawer open so that residual water can evaporate.
4. If you have finished using the washing machine, turn off the water and mains supplies.

Maintenance - Cleaning the Washing Machine



Always unplug the washing machine before cleaning.

Cleaning the Drum

Rust left inside the drum by metal articles should be removed immediately with chlorine-free detergent. Never use steel wool.



Don't put laundry in the washing machine during the drum cleaning.

Cleaning the Exterior of your Washing Machine

- Clean the outside of your washing machine with a soft cloth and mild detergent such as kitchen detergent.
- Don't splash water over the washing machine.
- Do not use cream cleansers, thinners or products containing alcohol or kerosene.

Cleaning the Detergent Drawer and Siphon Plug

1. Remove the detergent drawer by pulling and pressing gently on the rear centre part of the softener compartment.
2. Wash out old detergent from the drawer with water. (Use a cloth to clean the washing machine.) Residue detergent soon builds up if you don't clean the drawer regularly, and can develop mould.
3. Return drawer to original position.

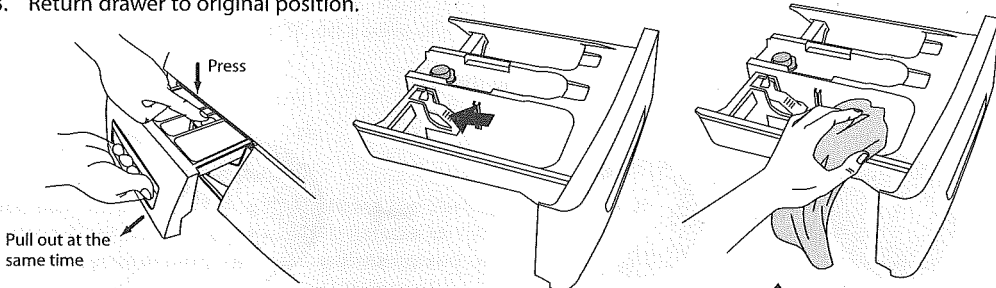

4. Disassemble the detergent drawer. Remove the siphon plug and clean the any residual softener thoroughly. Replace the cleaned siphon plug and check that it is fitted properly.

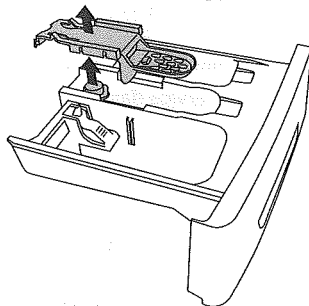

Cleaning the Door Seal and Window

- Wipe the window and seal after each wash to remove lint and stains. If lint builds up, it can cause leaks.
- Remove any coins, buttons and other objects from the door seal after each wash.

* All images are for indication only; please refer to your individual unit for actual item.

Cleaning the Drain Filter



Be careful not to burn yourself as water in the pump may be hot after a high temperature wash.

Before cleaning the drain filter, first start the spin programme, then switch off and unplug the washing machine.

1. Gently Open the Service Flap. Place a suitable container under the service flap to catch the water.

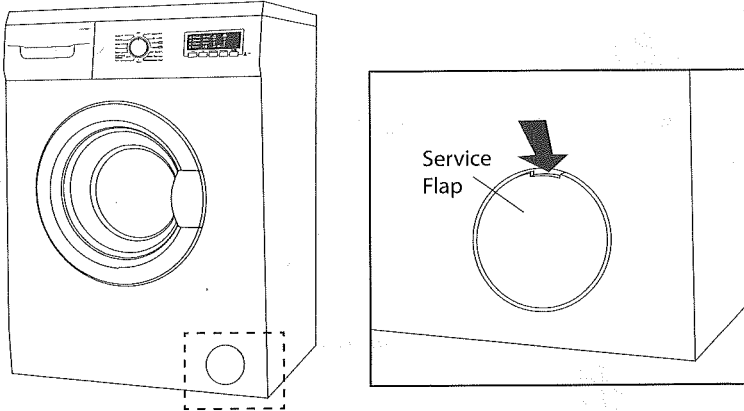

2. Carefully loosen the drain filter. Turn anti-clockwise until the water gently begins to run out, this is normal.
3. Remove the filter once the water has stopped.
4. Remove any lint and debris before carefully replacing the filter.

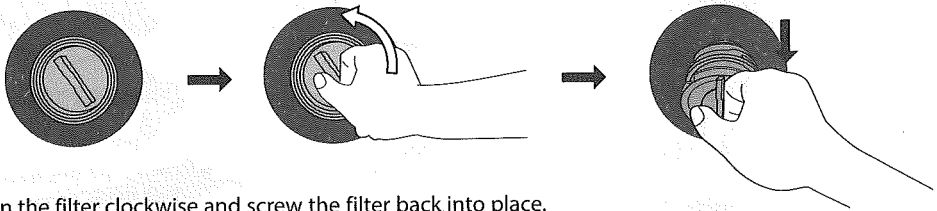

5. Turn the filter clockwise and screw the filter back into place.
6. Close the service flap.

* All images are for indication only; please refer to your individual unit for actual item.

Product Fiche

Model: C612WM17

Rated capacity: 6 kg

Energy efficiency class: A++

Energy consumption is 171 kwh per year based on 220 standard washing cycles for cotton programmes set at 60° C and 40° C, with full and partial loads, and the consumption of low-power modes. Actual energy consumption will depend on how the appliance is used.

Energy consumption of:

- Standard Cotton programme, 60° C, with a full load: 0.95 kwh
- Standard Cotton programme, 60° C, with a partial load: 0.60 kwh
- Standard Cotton programme, 40° C, with a partial load: 0.58 kwh

Power consumption when appliance is:

- Turned off: 0.09 W
- Left on: 0.67 W

Water consumption is 9900 litres per year based on 220 standard washing cycles for cotton programmes set at 60° C and 40° C, with full and partial loads.

Actual water consumption will depend on how the appliance is used.

Spin-drying efficiency class is "B", on a scale of A (most efficient) to G (least efficient).

Maximum spin speed: 1120 rpm

Remaining moisture content: 53%

Standard washing cycle programmes are the Standard 60° C Cotton Programme and the Standard 40° C Cotton Programme. These cycles are suitable for cleaning naturally-soiled laundry and are the most efficient washing cycles in terms of combined energy and water consumption.

Time required:

- Standard Cotton programme, 60° C, with a full load: 200 mins
- Standard Cotton programme, 60° C, with a partial load: 175 mins
- Standard Cotton programme, 40° C: 170 mins

Airborne acoustical noise (spinning): 78 dB

Airborne acoustical noise (standard 60° C): 58 dB

Specification

Brand	Currys Essentials
Model	C612WM17
Product Type	Washing Machine
Rated Voltage	220 - 240V~
Rated Frequency	50 Hz
Rated Power Input	2100 W
Dimensions of the Product	595mm (W) x 497mm (D) (excluding controls and door) x 845mm (minimum) (H)
Weight of the Product	63 kg
Maximum Mass of Dry Cloth	6 kg (Cotton programmes only)
Pressure of Tap Water	0.1 MPa - 1 MPa

Features and specifications are subject to change without prior notice.



For general information about this appliance
and handy hints and tips, please visit
www.knowhow.com/knowledgebank or call **0344 561 1234**.



Visit Partmaster.co.uk today for the easiest way to buy electrical spares and accessories. With over 1 million spares and accessories available we can deliver direct to your door the very next day.
Visit www.partmaster.co.uk or call 0344 800 3456 (UK customers only) Calls charged at National Rate.



The symbol on the product or its packaging indicates that this product must not be disposed of with your other household waste. Instead, it is your responsibility to dispose of your waste equipment by handing it over to a designated collection point for the recycling of waste electrical and electronic equipment. The separate collection and recycling of your waste equipment at the time of disposal will help conserve natural resources and ensure that it is recycled in a manner that protects human health and the environment.

For more information about where you can drop off your waste for recycling, please contact your local authority, or where you purchased your product.

DSG Retail Ltd. (co. no. 504877)
1 Portal Way, London, W3 6RS, UK

IB-C612WM17-170531V1